

**SV8.5**  
36mm x 10.5mm



Standard Replacement

| Range        | Part No. | Pack    | Qty. | Watts | Base  | ECE/ADR |
|--------------|----------|---------|------|-------|-------|---------|
| 12V Standard | 12844    | Box     | 10   | 5W    | SV8.5 | C5W     |
| 12V Standard | 12844B2  | Blister | 2    | 5W    | SV8.5 | C5W     |
| 12V Standard | 12854    | Box     | 10   | 10W   | SV8.5 | -       |
| 12V Standard | 12854B2  | Blister | 2    | 10W   | SV8.5 | -       |
| 24V Standard | 13844    | Box     | 10   | 5W    | SV8.5 | C5W     |
| 24V Standard | 13854    | Box     | 10   | 10W   | SV8.5 | -       |



LED Festoon Replacement

| Range       | Part No.     | Pack | Qty. | Kelvin | Watts | Base    | ECE/ADR |
|-------------|--------------|------|------|--------|-------|---------|---------|
| 12V Premium | 129446000KX1 | Box  | 1    | 6000K  | 1W    | 10.5x38 | -       |
| 24V Premium | 249446000KX1 | Box  | 1    | 6000K  | 1W    | 10.5x38 | -       |

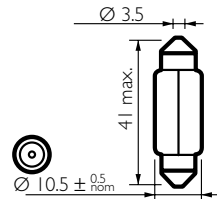

**SV8.5**  
41mm x 10.5mm



Standard Replacement

| Range        | Part No. | Pack    | Qty. | Watts | Base  | ECE/ADR |
|--------------|----------|---------|------|-------|-------|---------|
| 12V Standard | 12864    | Box     | 10   | 5W    | SV8.5 | -       |
| 12V Standard | 12866    | Box     | 10   | 10W   | SV8.5 | -       |
| 12V Standard | 12866B2  | Blister | 2    | 10W   | SV8.5 | -       |
| 24V Standard | 13864    | Box     | 10   | 5W    | SV8.5 | -       |
| 24V Standard | 13866    | Box     | 10   | 10W   | SV8.5 | -       |